

Copyright: This document and all information contained herein is the sole property of Aysford Sansome. Reproduction in whole or in part is strictly forbidden and may not be issued to any third party for any purpose unless prior permission is obtained.

DO NOT SCALE THIS DRAWING
Contractor must verify all dimensions on site before commencing any work or preparing manufacturing drawings. If in doubt ask.

Base drawing from R.S. Coombs
Drawing no. 87/28

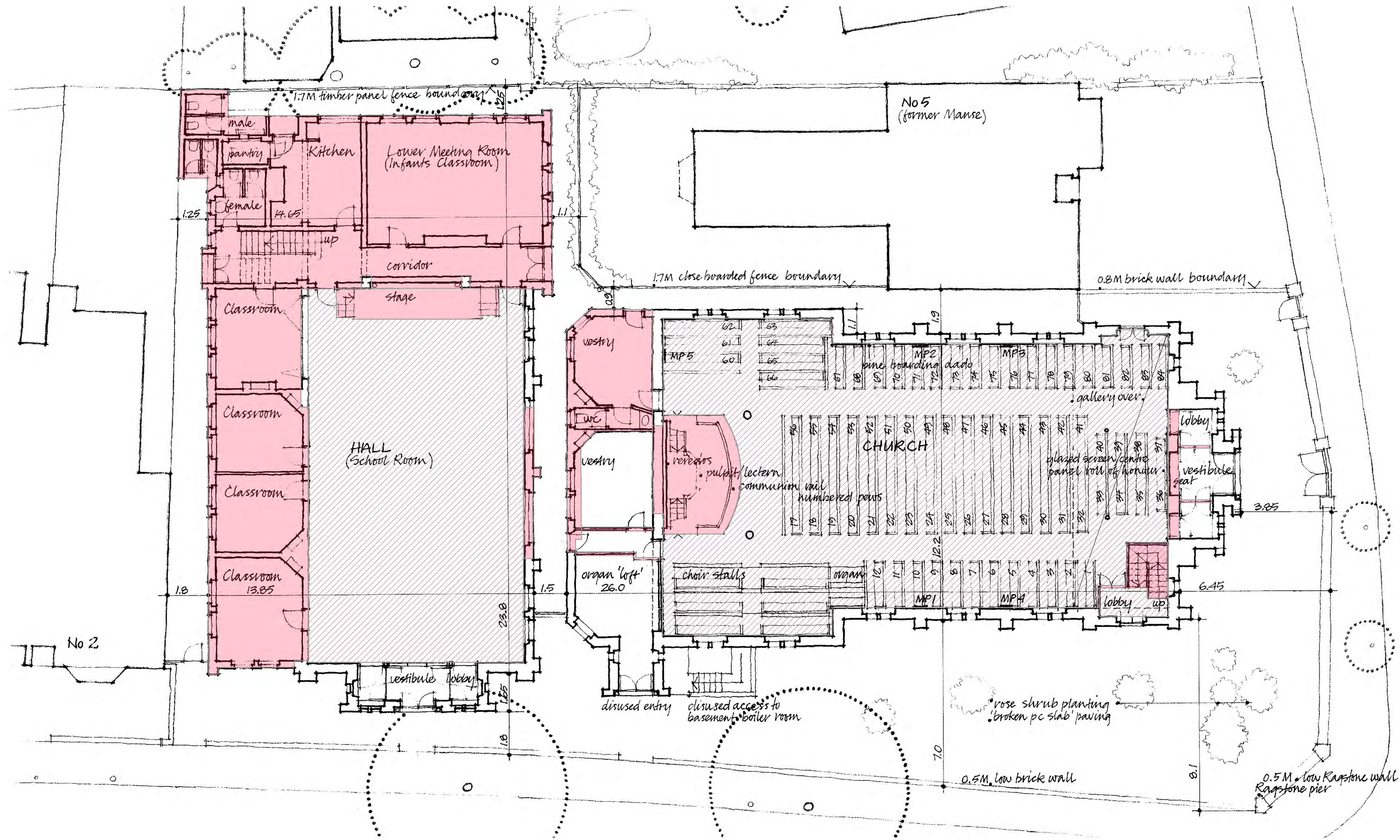

- Area of roof to be demolished
- For additional areas of roof demolition refer to first floor plan and elevation drawings.
- Area of ground floor concrete slab to be broken out and replaced

Rev	Revision Note	Date

Date	Sept 2019	Scale	1:100 @A1
------	-----------	-------	-----------

PLANNING
Project: Park Road Methodist Church Church Conversion to Residential Units Park Road Southend-on-Sea

Title	Ground Floor Demolition Plan
-------	------------------------------

Drig No.	1716/T/003
----------	------------

Chartered Architects	Post	6 Riverside House Lower Southend Road Wickford, SS11 8BB.	AYSFORD SANSOME
	Tel	01268 562266	
	Email	info@aysford.com	